

2019 BOND

JULY 2020 UPDATE



New Waller High School



New Waller High School

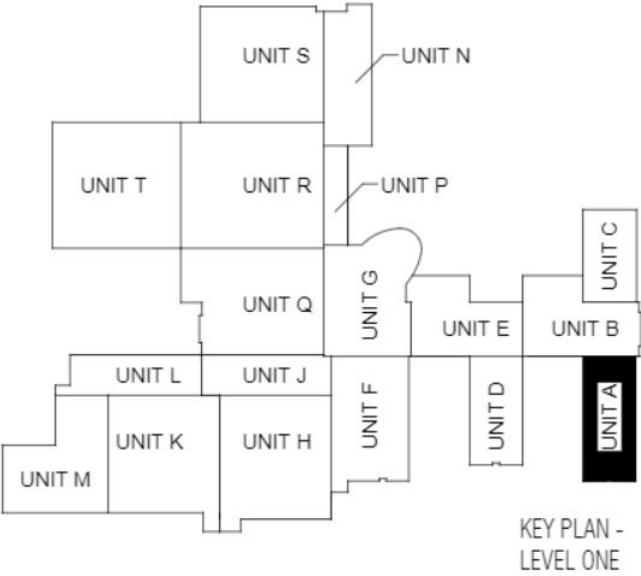

Aerial Photos - New Waller High School



Project Photos - New Waller High School



Drilled Piers



**Underground Plumbing
and Electrical**



Site Utilities



**Grade
Beams**

Project Photos - New Waller High School



Steel Erection started



**Slab on
Grade (SOG)
Concrete**

Project Update - New Waller High School

Completed/Current Activities

- Temporary power to construction trailer
- Detention Ponds – 99% complete
- Site Fill – complete
- Drilled Piers –complete
- Grade Beams – 40%
- Underground Plumbing Electrical – 40%
- Slab on Grade (SOG) Areas A, B, C, D, G
- Site Utilities and Drainage – 70%
- Site Paving started
- Building Steel erection started
- Package 2 sub-trade quotes received July 1st

Upcoming Activities

- Continue Grade Beams
- Underground Plumbing and Electrical
- Building Slab on Grade (SOG)
- Continue Site Utilities
- Site Drainage and Pavement
- Structural Steel Delivery and Erection
- Groundbreaking: TBD
- Package 2 GMP approved: July 20?

Thank You!

